



Aarzan Constructions

Redefining Luxury Living



Aarzan Residency

SPECIFICATIONS

1. Structure:

- RCC framed structure with columns and beams of M20 grade concrete and fe 500 ISI TMT Steel.
- Walls of concrete solid blocks.

2. Flooring or tiling:

- Living, Dining and Bedroom will be with vitrified flooring.
- Toilet wall tiles will be upto the ceiling. Antiskid floor tiles in toilets.

3. Kitchen:

- 2' dado above the counter.
- 20mm thick granite counters with edge polish.

4. Doors:

- Main door of teakwood with teakwood polish.
- All other doors will be solid panelled and water resistant paint for bath room doors.

5. Windows:

- High quality aluminium windows.

6. Electrification:

- Modular electrical switches of Anchor Roma or Equivalent.

7. Sanitary:

- All fixtures will be Parry Ware, Jaquar or equivalent.

8. Water:

- BWSSB and bore well with electrical pump.

9. Lift:

- Six Passengers.

Salient Features

- Aarzaan residency located in central Bangalore with close proximity to finest educational institutes, colleges, shopping centres and hospitals.
- It is a cosmopolitan and vibrant located with well developed infrastructure and is much sought after for business and residential location.
- 1 km from Cantonment Railway Station, 500m from Commercial Street, 1.5 km from M.G. Road.



TYPICAL FLOOR PLAN

SITE NO :7, R,No 3rd STREET, ARUNACHALAM MUDALIAR ROAD,
BANGALORE 560001

STILT FLOOR PLAN

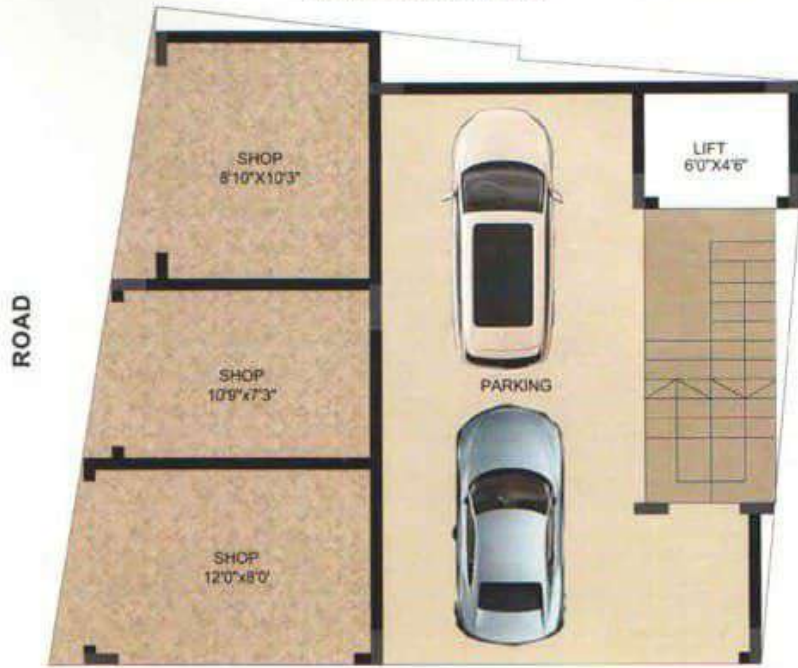

ROAD



Aarzan Constructions

Engineers & Contractors



#115, Seppings Road, Bangalore - 560 001

Mob: + 91-98866 62999

Email :aarzanconstructions@gmail.com

DISCLAIMER: Floor plans and other space are indicative and are subject to change as decided by the promoter or by any competent authority. The visual representation are artist's perspective only and are not representation of fact. This booklet is conceptual and not legal offering. The promoter reserves the right to change, alter, add or delete, any of the specifications mentioned herein without prior permission or notice. The Furniture and interior shown are only for the purpose of illustrating layout and does not form a part of the offering.

Architect Consultant : ARCHI DESIGNER

Structural Consultant : SK Structurals, Bangalore